



OPERATION GUIDE

## English Operation guide

### Pairing

The mifo O7 is a dual mode wireless device, meaning we have included full featured chipsets in each earbud. You may use one earbud or both, switching seamlessly between single or dual use.

#### Pairing for the first time

- ① Take both earbuds out of the charging case, right and left earbuds will connect automatically, it will default right earbud (mifo\_O7R) as the master one. During use, the one that connected with phone first will become the master one.
- ② From your device, search for Bluetooth devices and select either mifo\_O7R or mifo\_O7L. Because each earbud has independent functionality, it does not matter which you choose to pair with first.

- ③ 1~3 seconds later when the first earbud connects, the second earbud will also appear. Click to pair. (For compatibility reasons when using an iOS device, the pairing name will show as "Headset")

NOTES: If the pairing and connection failed, please operate again based on above operating steps.

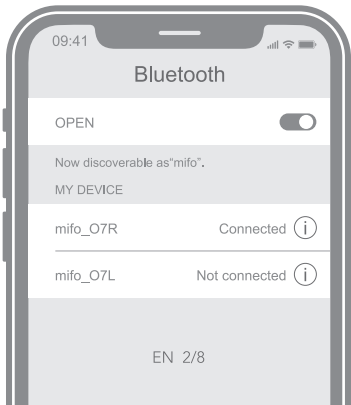

## Master-slave Switch Function

Switching between single and dual earbuds

- ① Place either earbud into the charging case during use. The remaining earbud will continue functioning with no interruption.
- ② To continue using two earbuds, simply remove an earbud from the charging case while one is in use.

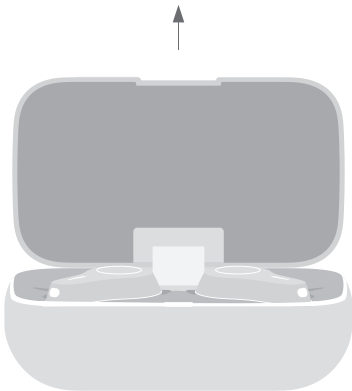

## Power Indicator Lights

Put the earbuds into the charging box, battery indicator will light up for 3 seconds to display the battery capacity.

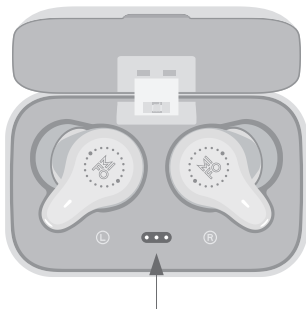

Full



70% remaining



30% remaining



Please Charge

## Touch Key Controls

The mifo O7 features touch control, and will turn off automatically if not paired with a device for 3 minutes.

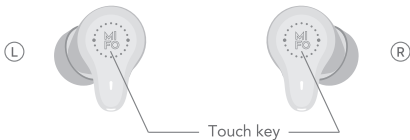

---

L

R

---

Double tap: Pause/Play

Double tap: Answer/hang up phone call



---

Single tap: Volume decrease

Triple tap: Previous Song



---

L

R

---

Single tap: Volume increase

Triple tap: Next song



---

Hold for 2Seconds to activate the voice assistant



---

Place the earbuds into the charging case for 1 minute, A white LED will flash.

Tap each earbud 5 times separately to reset.

If successful, the white LED will flash quickly 5 times.



## Important information about the earbuds

Please read the below information regarding the care of your product and your safety.

- ① Loud sounds may cause hearing loss. Maintain a safe listening volume and duration. Consult your physician to understand the appropriate volume and duration to avoid hearing loss.
- ② Maintain awareness of your surroundings. Earbuds may block ambient noise.
- ③ Do not use this product while operating a vehicle or heavy machinery.
- ④ Keep out of reach of children.
- ⑤ Not rated for use in dishwasher, laundry machine, or other cleaning devices.
- ⑥ If ear pain or discomfort results from the use of this product, please stop using and immediately consult a physician.
- ⑦ Do not store at temperatures below -15 degree C (5 degrees F) or above 55 degrees C (131 degrees F).



## FCC Compliance Statement

This device complies with Part 15 of the FCC Rules. Operation is subject to the following two conditions:

(1) this device may not cause harmful interference, and (2) this device must accept any interference received, including interference that may cause undesired operation.

NOTE: This equipment has been tested and found to comply with the limits for a Class B digital device, pursuant to part 15 of the FCC Rules. These limits are designed to provide reasonable protection against harmful interference in a residential installation. This equipment generates uses and can radiate radio frequency energy and, if not installed and used in accordance with the instructions, may cause harmful interference to radio communications. However, there is no guarantee that interference will not occur in a particular installation. If this equipment does cause harmful interference to radio or television reception, which can be determined by turning the equipment off and on, the user is encouraged to try to correct the interference by one or more of the following measures:

- Reorient or relocate the receiving antenna.
- Increase the separation between the equipment and receiver.
- Connect the equipment into an outlet on a circuit different from that to which the receiver is connected.
- Consult the dealer or an experienced radio/TV technician for help.

Changes or modifications not expressly approved by the party responsible for compliance could void the user's authority to operate the equipment.



DESIGNED AND MADE BY  
Mifo Technology Co.,Ltd.  
support@fiitii.com support@mifo.hk  
www.fiitii.com